

# Quick Guide

## Gmate® Origin

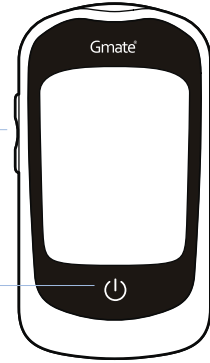





**Side Buttons (Up/Down Button)** are used to recall the stored results and adjust the parameters in setting mode.

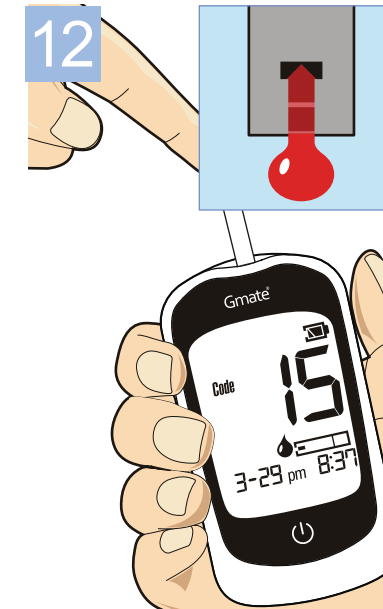
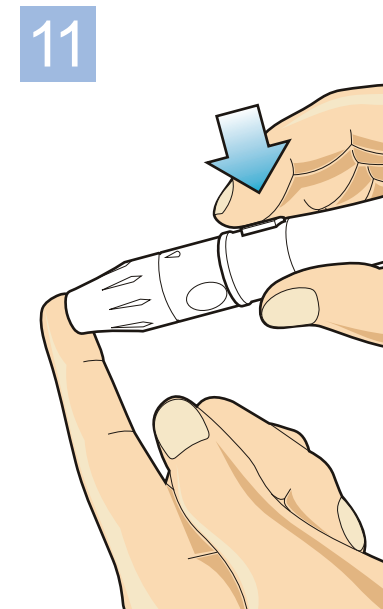
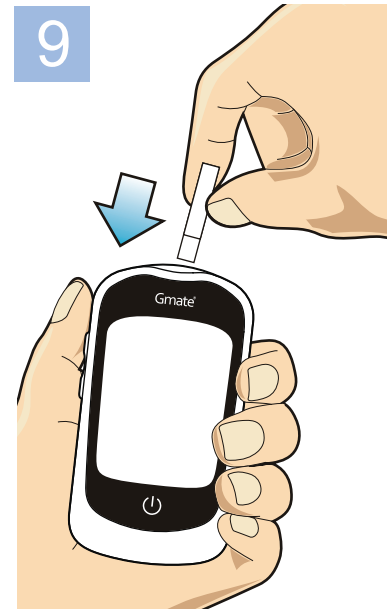
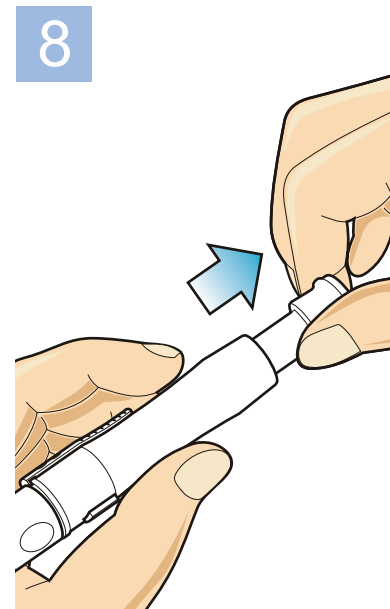
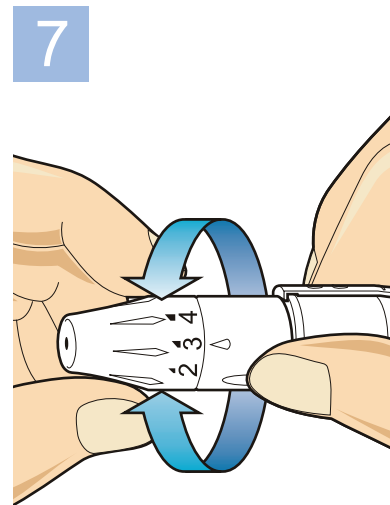
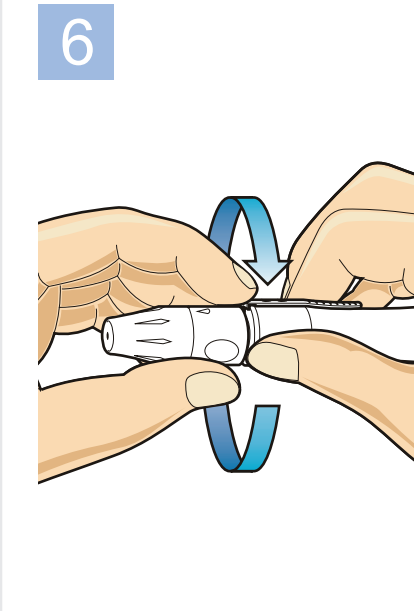
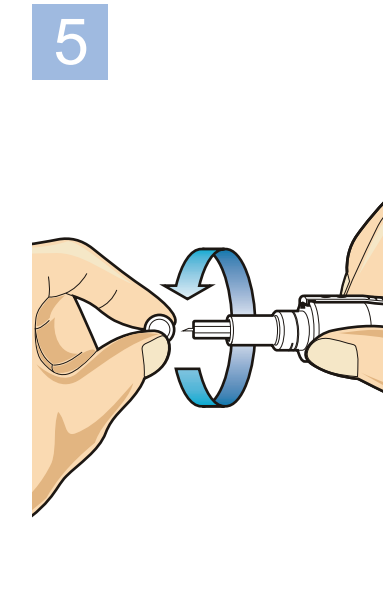
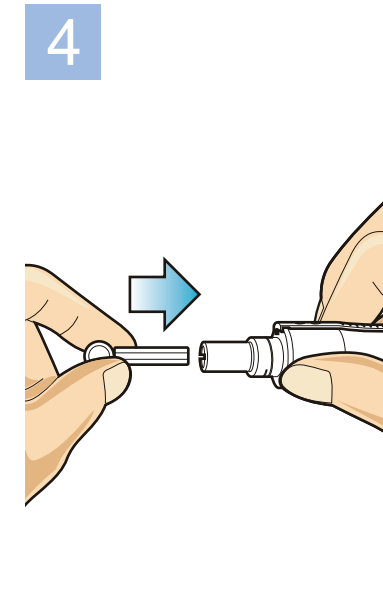
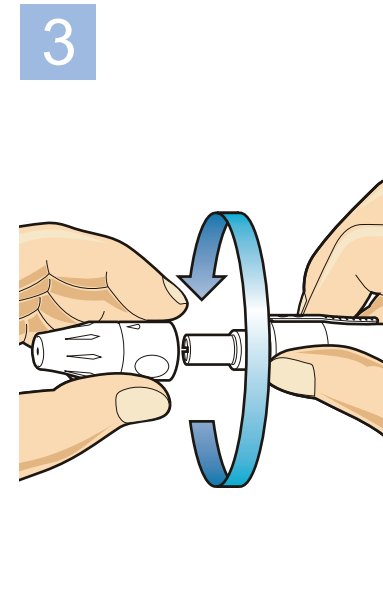
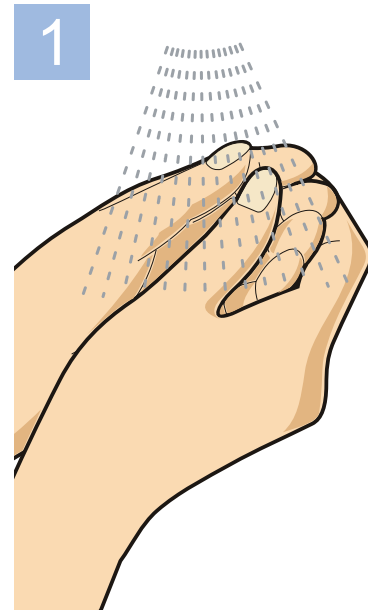

**Power Button** is used to meter on/off and change the meter modes.



-  **E01** When inserting a used test strip.
-  **E02** When the test strip may be inserted incorrectly or have a problem.
-  **E03** When the meter has a problem.
-  **E04** When environmental temperature is BELOW or ABOVE system operation range. (10~32°C)
-  **E05** Error message that may appear during your blood glucose testing. Please check "Testing Your Blood Glucose" page in the User's Guide and repeat the test with a new strip.